

# TWIN PORTS AERIAL

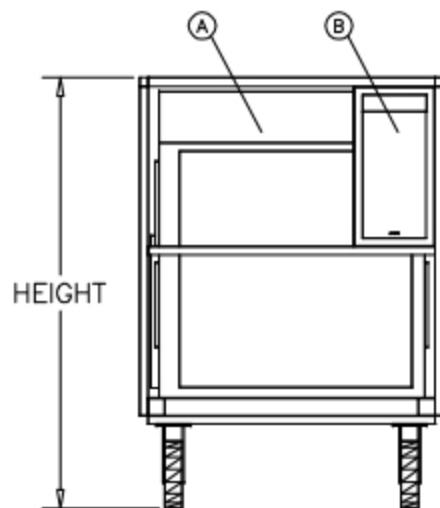

DULUTH, MN • (218) 728-4184

## PAC-3T4H

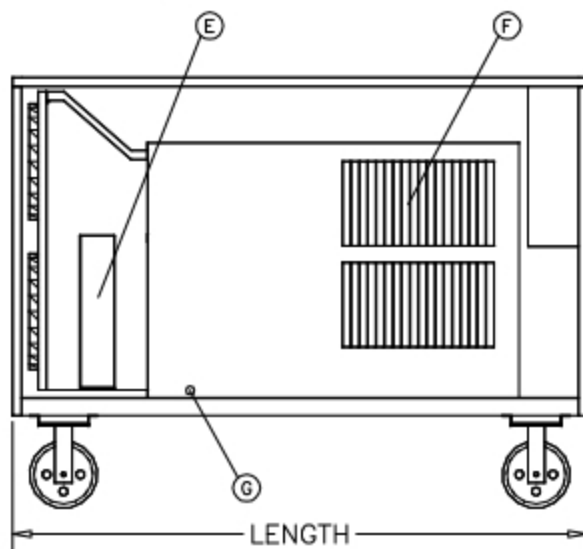
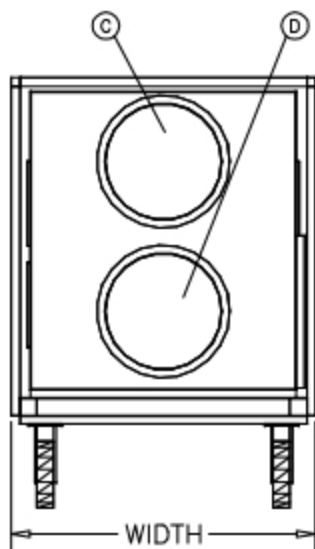

### UNIT SPECIFICATIONS:

POWER SUPPLY:	460V/3PH/60HZ
AIR DELIVERY:	1,200 CFM
HEATER ELEMENT:	17 KW
DRAIN CONNECTION:	1" NPT
SOUND POWER LEVEL:	79dba

- (A) CONDENSER INLET
- (B) SAFETY DISCONNECT
- (C) RETURN AIR 14" dia
- (D) SUPPLY AIR 14" dia
- (E) SERVICE ACCESS, FILTER
- (F) CONDENSER EXHAUST
- (G) CONDENSATE DRAIN CONNECTION

### MODE:

COOL ONLY:	10 MCA
HEAT OR COOL:	30 MCA

### DIMENSIONS:

LENGTH:	68"
WIDTH:	36"
HEIGHT:	51"
WEIGHT:	739 lb

DRAWN: ACJ	UPDATED: JH
DATE: 02/04/02	DATE: 02/17/17